



PLAN NO. 10/20
20.02.2023
Date: 05/05/2023

APPROVED

Commissioner
Durgapur Municipal Corporation

SUJOY BANERJEE
Planner-in-Charge, Building Plan
Durgapur Municipal Corporation

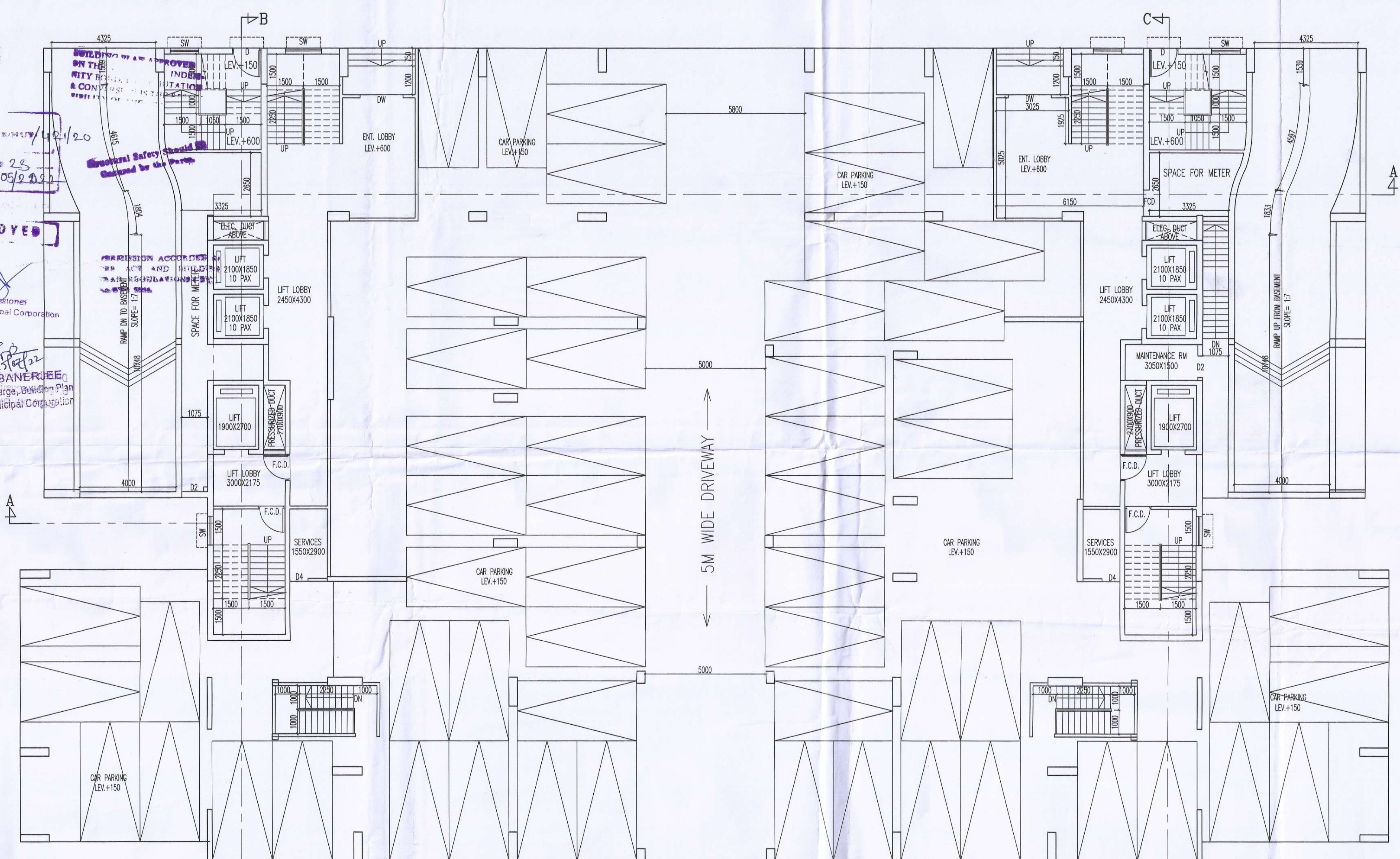

GROUND FLOOR PLAN
SCALE - 1:100

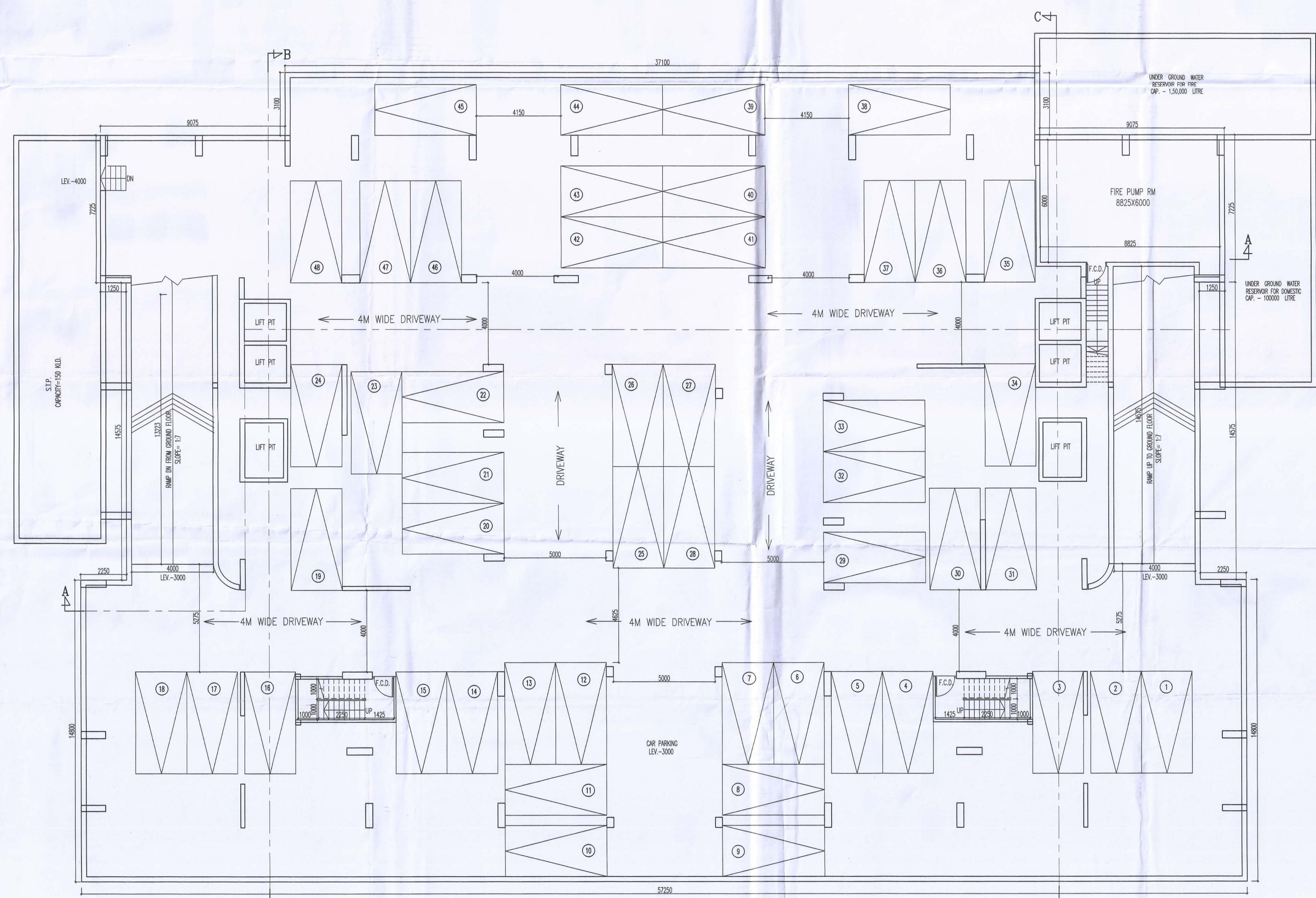

BASEMENT PLAN
SCALE - 1:100

SCHEDULE OF DOORS & WINDOWS

TYPE	SILL	UNTEL	SIZE	TYPE	SILL	UNTEL	SIZE
DA	-	2150	1500X2150	W	950	2150	1800X1200
D	-	2150	1200X2150	W1	450	2150	1500X1700
D1	-	2150	1100X2250	W2	450	2150	1200X1700
D2	-	2150	800X2150	W3	450	2150	2000X1700
D4	-	2150	750X2150	W4	1550	2150	800X1100
DW	-	2100	1800X2150	WS	950	2150	1200X1200
DW1	-	2100	1500X2150	V	1200	2150	500X950
DCD	-	2150	1100X2250				

GENERAL NOTES

1. ALL DIMENSIONS ARE IN MM.
2. ALL EXTERNAL WALLS 200 THK. & INTERNAL WALLS 75 THK. UNLESS OTHERWISE MENTIONED.
3. ALL MASONRY WORKS ARE BOUNDED BY CEMENT MORTAR (1:6) & (1:4).
4. EXTERNAL PLASTER IS 25 THK. & INTERNAL PLASTER IS 12MM. THK. WITH 1:4 MORTAR.
5. ALL CONC. GRADE IS M200 (1:1.5:3).
6. ALL WARDROBES ARE 500 MM. WIDE.

DISCLAIMER

THE DIMENSIONS WHICH ARE SHOWN IN THE SANCTION PLAN (OR SALE DRAWING) APPROVED BY THE AUTHORITIES ARE BARE ARCHITECTURAL DIMENSIONS. PHYSICAL DIMENSION POST FINISHING WILL REDUCE DUE TO FINISHES SUCH AS PLASTER, POP, FLOORING ETC, RESULTING SOME REDUCTION IN CARPET AREA.

UNDERSIGNED HAS INSPECTED THE SITE AND CARRIED OUT SOIL INVESTIGATION THEREON. IT IS CERTIFIED THAT THE EXISTING SOIL OF THE SITE IS ABLE TO CARRY THE LOAD COMING FROM THE PROPOSED CONSTRUCTION AND THE FOUNDATION SYSTEM PROPOSED HEREIN IS SAFE & STABLE IN ALL RESPECT FROM GEOTECHNICAL POINT OF VIEW.

SIGNATURE OF GEOTECH ENGINEER

DR. SUJIT KUMAR BOSE
Ph.D., M.C.E.(Soil), B.C.E.(Hons.)
MIGS, MIRC
Empaneled Geotechnical Engineer Under KMC
Licence No.-G.T./1/12

SIGNATURE OF L.B.S.

1. I ENGAGED ARCHITECT AND E.S.E DURING CONSTRUCTION
2. I FOLLOWED THE INSTRUCTIONS OF ARCHITECT AND E.S.E DURING CONSTRUCTION OF THE BUILDING.
3. KMC AUTHORITY WILL NOT BE RESPONSIBLE FOR STRUCTURE STABILITY OF BUILDING AND ADJOINING STRUCTURE.
4. IF ANY SUBMITTED DOCUMENT IS FOUND TO BE FAKE THE KMC AUTHORITY MAY REVOKE THE SANCTION PLAN.
5. THE CONSTRUCTION OF WATER RESERVOIR AND SEPTIC TANK EXECUTED UNDER THE GUIDANCE OF ARCHITECT & E.S.E.

SIGNATURE OF OWNER

SUKHSAGAR HIRSE PVT. LTD.
Director/Authorized Signatory

CERTIFICATE OF ARCHITECT

THE L.B.A. HAS CERTIFIED ON THE PLAN ITSELF WITH FULL RESPONSIBILITY THAT THE BUILDING PLAN HAS BEEN DRAWN UP AS PER PROVISION OF K.M.C. BLDG. RULES 2009, AS AMENDED FROM TIME TO TIME AND THAT THE SITE CONDITION INCLUDING THE WIDTH OF THE ABUTTING ROAD CONFIRM WITH THE PLAN AND IT IS A BUILD ABLE SITE AND NOT A TANK OR A FILLED UP TANK.

SIGNATURE OF ARCHITECT

Rajkumar Agarwal
Architect
Member of Council of Architecture CA / 94 / 17940

CERTIFICATE OF STRUCTURAL ENGINEER

THE STRUCTURAL DESIGN OF BOTH FOUNDATION AND SUPERSTRUCTURE OF THE BUILDING HAVE BEEN MADE BY ME CONSIDERING ALL POSSIBLE LOADS INCLUDING THE SEISMIC LOAD AS PER N.B.C OF INDIA AND CERTIFY THAT IT IS SAFE AND STABLE IN ALL RESPECT. THE RECOMMENDATION OF SOIL REPORT HAS BEEN CONSIDERED DURING STRUCTURAL CALCULATION.

SIGNATURE OF STRUCTURAL ENGINEER

SAHAY PAREKH
M.E.(STRUCTURE), M.E.(CONST. ENG.)
B.C.E., FIE (F-18202-4)
ENLISTED STRUCTURAL REVIEWER-10413 K.M.C.

SIGNATURE OF STRUCTURAL REVIEWER

TITLE

BASEMENT PLAN & GROUND FLOOR PLAN.

PROJECT

PROPOSED PLAN OF B+G+XVIII STORED (59.05 M. HT.) RESIDENTIAL BUILDING AT HOLDING NO.-184/N, C/W NO.-C/20, L.R. KHATAN NO.-7456, J.L. NO.-119, SEBEK DAG NO.-1294, 1296, 1297, 1298, 1299, 1300, 1320, HAL DAG NO.-1334, 1333, 1332, (1329,1330,1331) 1318, 1317, 1328, MOUZA-BHIRINGI, G.T. ROAD, DURGAPUR-13, P.S.-DURGAPUR (FARIDPUR), DISTRICT - BURDWAN.

DATE 17.05.22 **DRG.NO** ARCH/2010/318 **DEALT** MITHUN **CHECKED** NIRMAL **SHEET NO** 2 OF 6

SCALE 1:100 **ARCHITECT** RAJ AGRAWAL & ASSOCIATES 8B, ROY STREET, CALCUTTA - 16